



PML LINE

**VK**  
**systems**

CATALOG 2019-2020

# CONTENT

## PRODUCT

<b>Linie PML</b>	<b>3</b>
Order overview PML Line	4
<b>Pneumatic chucks</b>	<b>6</b>
 Pneumatic chucks, flexible and modular systems for the production	6
Jaws set 3 PML Complete (inside and outside)	7
<b>Accessoires PML Line</b>	<b>8</b>

## Contact

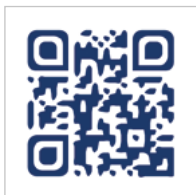

VK SYSTEMS PLC  
Kastellstrasse 11  
CH-8623 Wetzikon  
Switzerland

PHONE  
+41 44 970 20 00  
E-MAIL  
[info@vk-systems.ch](mailto:info@vk-systems.ch)

## PML Line

Pneumatic chucks of the PML series are characterised predominantly by their large jaw stroke. With (complete) jaws, components can be clamped using roller pins over the whole chuck diameter, continuously and without changing the set-up. Vertical stops can be fixed using the threads on the chuck body.

In this way, clamped workpieces can be positioned at the required height. Ideal for use with tactile measuring machines with star styli.

Components of the PML series are made from aluminium and coated with EMATEF® as standard. The coating gives the jaws good surface slip and almost no frictional resistance.

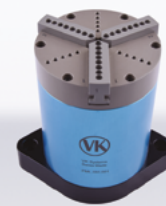



Pneumatic chucks



Concentricity	Repetitive accuracy	Lateral runout
0,03mm	0,01mm	0,01mm

Application:
Measuring technology
Automation
Laser and gravure technology



	Article	Designation	Package Contents
<b>FLEXIBLE AND MODULAR SYSTEMS FOR THE PRODUCTION</b>			
	PML.080.000	Chuck 3 PML 80 basic	<b>Chuck without jaws</b> , push-in fittings for hose external Ø 6mm
	PML.125.000	Chuck 3 PML 125 basic	
	PML.160.000	Chuck 3 PML 160 basic	
	PML.080.001	Chuck 3 PML 80 basic plus	<b>Pneumatic chucks with 1-set clamping jaws for position pins</b> , push-in fittings for hose external Ø 6mm and adaptation plate for integration
	PML.125.001	Chuck 3 PML 125 basic plus	
	PML.160.001	Chuck 3 PML 160 basic plus	
	PML.080.002	Chuck 3 PML 80 basic plus	<b>Chuck with 1 set of clamping jaws for position pins</b> , adaptation plate for integration, control unit for clamping pressure and speed of jaws
	PML.125.002	Chuck 3 PML 125 basic plus	
	PML.160.002	Chuck 3 PML 160 basic plus	



	Article	Designation	Package Contents
<b>CLAMPING JAWS FOR PML LINE</b>			
	PML.080.013	Jaws set 3 PML 80 complete	<b>Set of aluminium jaws</b> , ematef® coated with position holes for pins
	PML.125.013	Jaws set 3 PML 125 complete	
	PML.160.013	Jaws set 3 PML 160 complete	

**FLEXIBLE AND MODULAR SYSTEMS FOR THE PRODUCTION**

Technical data and ordering overview Type PML (3-jaw chuck)

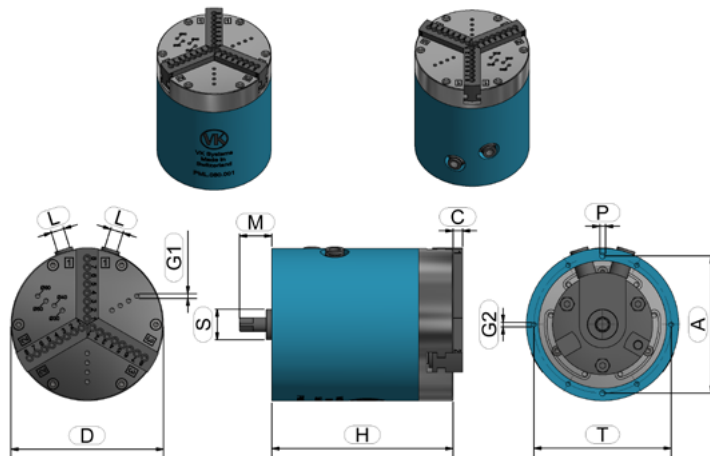

Size		80
A +/-0,01	Distance Fit [mm]	72
C	Jaw height (Standard) [mm]	5
D	Diameter [mm]	80
G1	Thread for height stop [mm]	12 x M3
G2	Thread for mounting [mm]	6 x M3
H	Maximum height [mm]	95
L	Air connection [mm]	6
M	Projection of part-turn actuator [mm]	17
P [H7]	Interface Fit [mm]	3 (2-Stück)
S	Interference circuit, rotary actuator [mm]	16
	max. inlet pressure [bar]	8
	Jaw stroke [mm / Ø]	10
	Weight [kg]	1,4
<b>Order number (without jaws)</b>		<b>PML.080.000</b>

### JAWS SET 3 PML COMPLETE (INSIDE AND OUTSIDE)

Technical data and ordering overview

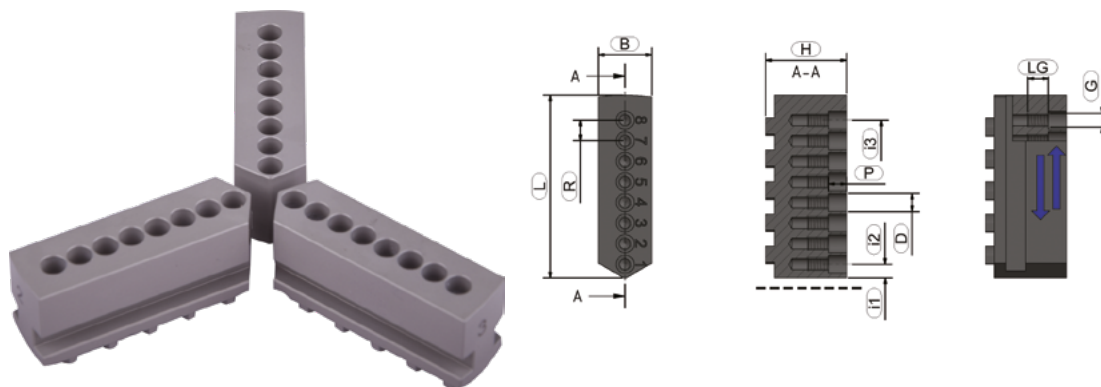

	Size	80
i1	Clamping range [mm / Ø]	1 – 10
i2	Clamping range [mm / Ø]	7 – 25
i3	Clamping range [mm / Ø]	66 – 84
H	Maximum height [mm]	18
L	Total length [mm]	40
R +/-0,01	Screening [mm]	4,5
B	Jaw width [mm]	11,7
D [G8]	Precision bore [mm]	4
P	Fit length [mm]	4
G	Thread	M3
LG	Thread length [mm]	4,5
	<b>Order number (without Chuck)</b>	<b>PML.080.013</b>

**MAINTENANCE AND CONTROL SET FOR COMPRESSED AIR**

TYPE ACCESSORIES PNEUMATIC CHUCK PML

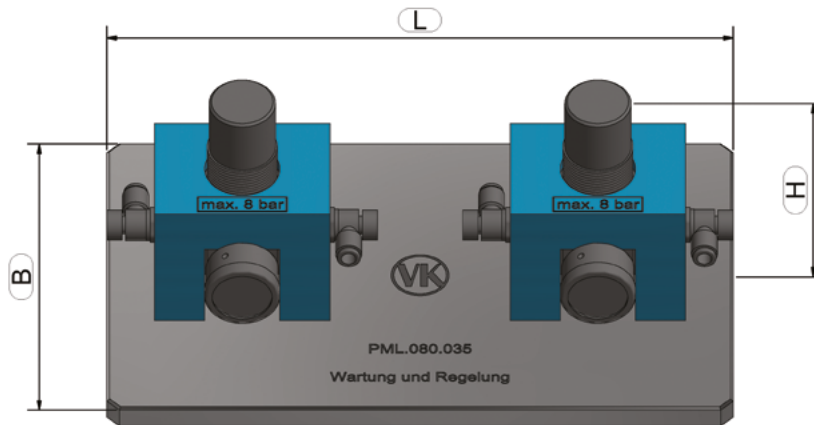

**Key advantage**

- *Infinitely variable adjustment of jaw clamping force (internal and external clamping) via controller*
- *Infinitely variable speed control of jaw stroke via throttle valve*
- *Easy integration into automation processes*

	Compatible with size 80, 125 and 160	Mass
B	Total width [mm]	250
H	Maximum height [mm]	93
L	Total length [mm]	350
	Max. inlet pressure [bar]	10
	<b>Order number (without Chuck)</b>	<b>PML.080.035</b>



### BASE PLATE FOR GRID PLATE

TYPE ACCESSORIES PNEUMATIC CHUCK PML.080.000

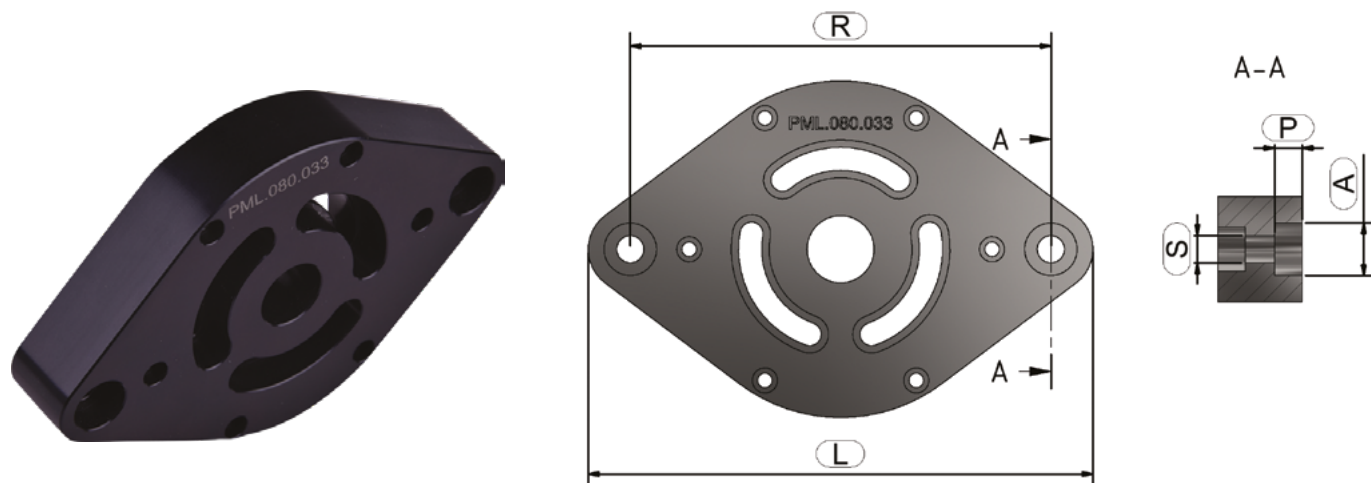

#### Key advantage

- Fast positioning on measuring machines with grid plate
- Base plate can be positioned accurately and identically for recurring series

	Compatible with size 80	Mass
A [G8]	Interface [mm]	12,5
P	Fit length [mm]	6,5
S	Mounting	2 x M6
L	Total length [mm]	120
R +/-0,01	Screening [mm]	100
	Maximum height [mm]	20
	<b>Order number (without Chuck)</b>	<b>PML.080.033</b>



Swiss Made