



UFS line

VK
systems

CATALOG 2019-2020

CONTENT

PRODUCT

UFS Line	3
Order overview UFS Line	4
3-Jaws Precision chuck made on stainless steel	6
Flat and light construction with basic- and top jaws	6
 Jaw-Set 3 UFS Complete (inside and outside)	7
Jaw-Set 3 UFS Bloc (Blockback)	8
Precision chuck with 6- or 8-jaws made of stainless steel	9
Flat and light construction with basic- and top jaws	9
 Jaw-Set UFS Complete (inside and outside)	10
Jaw-Set UFS Bloc (Blockback)	11
Order overview UFS Ring chuck Line	12
Ring chuck made of stainless steel	14
Form fit clamping with basic- and top jaws	14
 Jaw-Set UFS Inside (inside)	15
Jaw-Set UFS Outside (outside)	16
Jaw-Set UFS Bloc (Blockback)	17

Contact



VK SYSTEMS PLC
Kastellstrasse 11
CH-8623 Wetzikon
Switzerland

PHONE
+41 44 970 20 00
E-MAIL
info@vk-systems.ch

UFS Line

All the chuck of the line UFS are made of rust-free high-grade steel.

UFS is very flat, light and available with 3-, 6- or 8-jaws.

UFS lines are smooth-running and continuously adjustable. Due to a coating on the spiral the chuck need a low maintenance and can be used in water, alimentary and medical technology.

The jaws are vacuum -hardened and polished.

The tightening and loosening function works by turning the spiral by hand or pin.

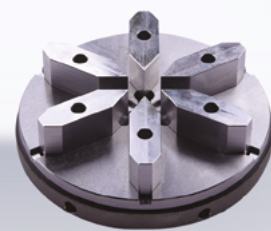







Precision chuck







Concentricity	Repetitive accuracy	Lateral runout
0,02mm	0,005mm	0,01mm

Application:
Erode
Manufacturing engineering
Grinding
Measuring technology
Automation



	Article	Designation	Package Contents
3-JAWS CHUCK MADE OF STAINLESS STEEL FOR ERODE, PRECISION MECHANICS, GRINDING, MEASUREMENT AND AUTOMATISATION			
	UFS.055.003	Chuck 3 UFS 55 basic	Chuck with 1-set basic jaws without top jaws , clamping key, TORX® screwdriver, cylinder head screws (stainless)
	UFS.070.003	Chuck 3 UFS 70 basic	
	UFS.100.003	Chuck 3 UFS 100 basic	
	UFS.150.003	Chuck 3 UFS 150 basic	
	UFS.055.004	Chuck 3 UFS 55 complete	Chuck with 1-set basic jaws and reversible top jaws for inside and outside clamping , clamping key, TORX® screwdriver, head screws (stainless)
	UFS.070.004	Chuck 3 UFS 70 complete	
	UFS.100.004	Chuck 3 UFS 100 complete	
	UFS.150.004	Chuck 3 UFS 150 complete	
	UFS.055.005	Chuck 3 UFS 55 bloc	Chuck with 1-set basic- and bloc jaws , clamping key, TORX® screwdriver, cylinder head screws (stainless)
	UFS.070.005	Chuck 3 UFS 70 bloc	
	UFS.100.005	Chuck 3 UFS 100 bloc	
	UFS.150.005	Chuck 3 UFS 150 bloc	
6- OR 8-JAWS CHUCK MADE OF STAINLESS STEEL FOR ERODE, PRECISION MECHANICS, GRINDING, MEASUREMENT AND AUTOMATISATION			
	UFS.055.000	Chuck 6 UFS 55 basic	Chuck with 1-set basic jaws without top jaws , clamping key, TORX® screwdriver, cylinder head screws (stainless)
	UFS.070.000	Chuck 6 UFS 70 basic	
	UFS.100.000	Chuck 6 UFS 100 basic	
	UFS.150.000	Chuck 8 UFS 150 basic	
	UFS.055.001	Chuck 6 UFS 55 complete	Chuck with 1-set basic jaws and reversible top jaws for inside and outside clamping , clamping key, TORX® screwdriver, head screws (stainless)
	UFS.070.001	Chuck 6 UFS 70 complete	
	UFS.100.001	Chuck 6 UFS 100 complete	
	UFS.150.001	Chuck 8 UFS 150 complete	
	UFS.055.002	Chuck 6 UFS 55 bloc	Chuck with 1-set basic- and bloc jaws , clamping key, TORX® screwdriver, cylinder head screws (stainless)
	UFS.070.002	Chuck 6 UFS 70 bloc	
	UFS.100.002	Chuck 6 UFS 100 bloc	
	UFS.150.002	Chuck 8 UFS 150 bloc	



	Article	Designation	Package Contents
CLAMPING JAWS FOR UFS LINE			
	UFS.055.013	Clamping Jaws 3 UFS 55 complete	Reversible top jaws for inside- and outside clamping (hardened / ground)
	UFS.070.013	Clamping Jaws 3 UFS 70 complete	
	UFS.100.013	Clamping Jaws 3 UFS 100 complete	
	UFS.150.013	Clamping Jaws 3 UFS 150 complete	
	UFS.055.014	Clamping Jaws 6 UFS 55 complete	Reversible top jaws for inside- and outside clamping (hardened / ground)
	UFS.070.014	Clamping Jaws 6 UFS 70 complete	
	UFS.100.014	Clamping Jaws 6 UFS 100 complete	
	UFS.150.014	Clamping Jaws 6 UFS 150 complete	
	UFS.055.020	Clamping Jaws 3 UFS 55 bloc	Bloc Jaws made of stainless steel
	UFS.070.020	Clamping Jaws 3 UFS 70 bloc	
	UFS.100.020	Clamping Jaws 3 UFS 100 bloc	
	UFS.150.020	Clamping Jaws 3 UFS 150 bloc	
	UFS.055.019	Clamping Jaws 6 UFS 55 bloc	Bloc Jaws made of stainless steel
	UFS.070.019	Clamping Jaws 6 UFS 70 bloc	
	UFS.100.019	Clamping Jaws 6 UFS 100 bloc	
	UFS.150.019	Clamping Jaws 6 UFS 150 bloc	

FLAT AND LIGHT CONSTRUCTION WITH BASIC- AND TOP JAWS

Technical data and order overview Typ UFS (3-Jaw chuck)

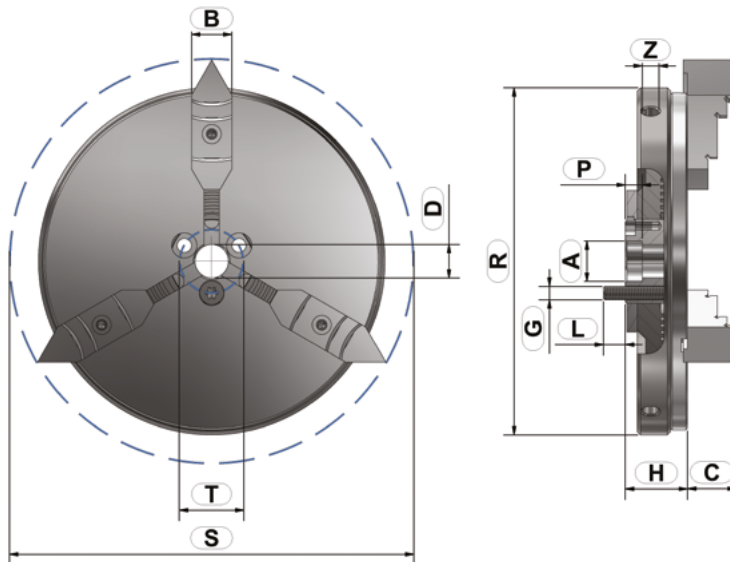

Sizes		55	70	100	150
A 0/+0,01	Interface [mm]	10	11	12	20
B	Jaw width [mm]	8	10	12	18
C	Jaw height (Standard) [mm]	9	10,5	14,5	18,5
D	Ø center hole [mm]	8	8	10	16
G	Fixing screws	3 x M3	3 x M3	3 x M4	4 x M5
H	Height without Jaws [mm]	14	16	18,5	21,5
L	Thread length [mm]	5,75	4,5	6,5	5
P	Fit lenght [mm]	5	5	5	5
R	Outside-Ø [mm]	58	73	103	153
S	Max. circuit diameter [mm]	73,5	87,5	119,5	183,5
T	Circle for mounting [mm]	14,5	17	18,8	28
Z	Clamping bore [mm]	-	3	5	5
	Concentricity [mm]	0,02	0,02	0,02	0,02
	Rotation speed n max. [1/min.]	2500	2500	2000	1500
	Travel path [mm im Ø]	15	23,5	36,5	47
	Weight [mm]	0,3	0,5	1	2,5
	Order number (without jaws)	UFS.055.000	UFS.070.000	UFS.100.000	UFS.150.000

JAW-SET 3 UFS COMPLETE (INSIDE AND OUTSIDE CLAMPING)

Technical data and order overview

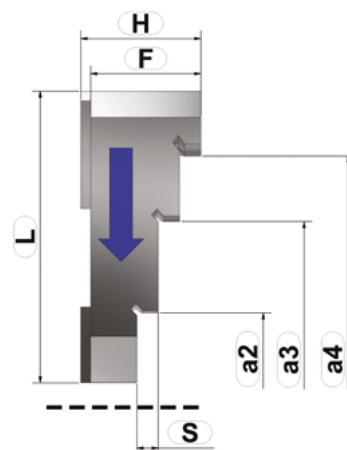
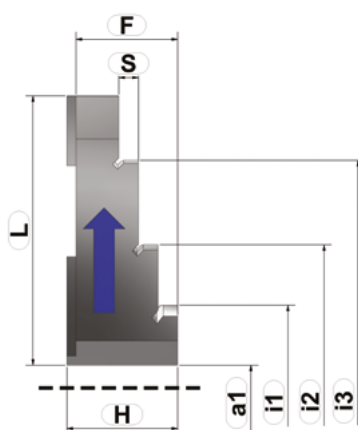

Sizes		55	70	100	150
a1	Clamping range outside	1 - 16	1 - 24	1 - 37	1 - 48
a2		25 - 39	28 - 50	34 - 69	51 - 98
a3		38 - 52	44 - 66	57 - 92	78 - 125
a4		52 - 66	57 - 79	75 - 110	116 - 163
i1	Clamping range inside	14 - 29	14 - 37	19 - 55	32 - 79
i2		27 - 42	26 - 49	36 - 72	70 - 117
i3		50 - 55	42 - 65	60 - 96	95 - 142
F	Height from Chuck body	9	10,5	14,5	18,5
H	Maximum height [mm]	10	11,5	15,5	19,5
L	Total length [mm]	24,5	26	38,5	60
S	Step height	2	2,3	2,8	4
	Jaw width [mm]	8	10	12	18
Order number (without Chuck)		UFS.055.013	UFS.070.013	UFS.100.013	UFS.150.013

JAW-SET 3 UFS BLOC (BLOCKBACK)

Technical data and order overview



Sizes		55	70	100	150
F	Height from Chuck body	9	10,5	14,5	18,5
H	Maximum height [mm]	10	11,5	15,5	19,5
L	Total length [mm]	24,5	26	38,5	60
	Jaw width [mm]	8	10	12	18
	Order number (without jaws)	UFS.055.000	UFS.070.000	UFS.100.000	UFS.150.000

FLAT AND LIGHT CONSTRUCTION WITH BASIC- AND TOP JAWS

Technical data and order overview Typ UFS (6- oder 8-Jaw chuck)

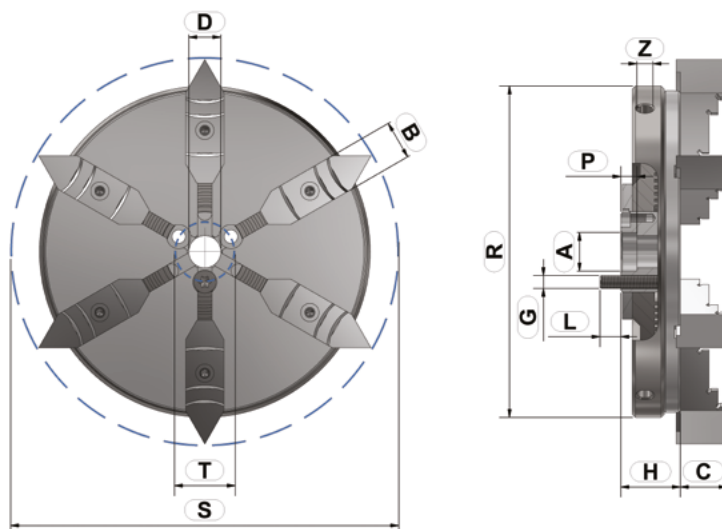

Sizes		55	70	100	150
A 0/+0,01	Interface [mm]	10	11	12	20
B	Jaw width [mm]	8	10	12	18
C	Jaw height (Standard) [mm]	9	10,5	14,5	18,5
D	∅ center hole [mm]	8	8	10	16
G	Fixing screws	3 x M3	3 x M3	3 x M4	4 x M5
H	Height without Jaws [mm]	14	16	18,5	21,5
L	Thread length [mm]	5,75	4,5	6,5	5
P	Fit length [mm]	5	5	5	5
R	Outside-∅ [mm]	58	73	103	153
S	Max. circuit diameter [mm]	73,5	87,5	119,5	183,5
T	Circle for mounting [mm]	14,5	17	18,8	28
Z	Clamping bore [mm]	-	3	5	5
	Concentricity [mm]	0,02	0,02	0,02	0,02
	Rotation speed n max. [1/min.]	2500	2500	2000	1500
	Travel path [mm im ∅]	15	23,5	36,5	47
	Weight [mm]	0,3	0,5	1	2,5
	Order number (without jaws)	UFS.055.000	UFS.070.000	UFS.100.000	UFS.150.000

JAW-SET UFS COMPLETE (INSIDE AND OUTSIDE CLAMPING)

Technical data and order overview

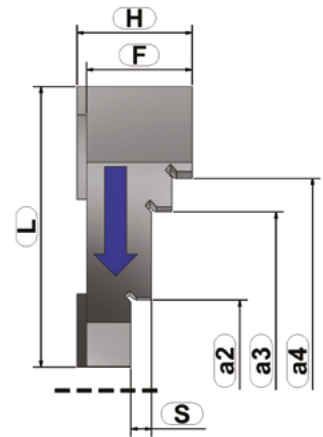
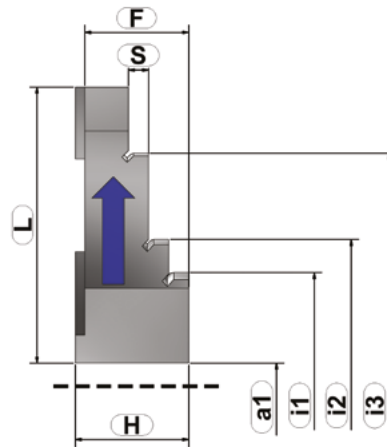

Sizes		55	70	100	150
a1	Clamping range outside	1 - 16	1 - 24	1 - 37	1 - 48
a2		25 - 39	28 - 50	34 - 69	51 - 98
a3		38 - 52	44 - 66	57 - 92	78 - 125
a4		52 - 66	56 - 78	68 - 103	104 - 151
i1	Clamping range inside	15 - 29	14 - 37	19 - 55	32 - 79
i2		28 - 42	26 - 50	36 - 72	70 - 117
i3		41 - 55	42 - 65	60 - 96	95 - 142
F	Height from Chuck body	9	10,5	14,5	18,5
H	Maximum height [mm]	10	11,5	15,5	19,5
L	Total length [mm]	24,5	26	38,5	60
S	Step height	2	2,3	2,8	4
	Jaw width [mm]	8	10	12	18
Order number (without Chuck)		UFS.055.013	UFS.070.013	UFS.100.013	UFS.150.013



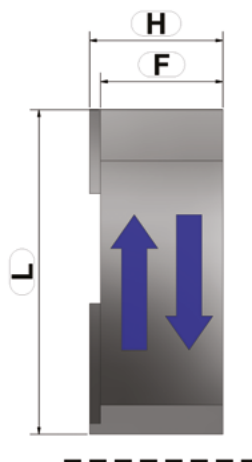

JAW-SET UFS BLOC (BLOCKBACKEN)

Technical data and order overview





Sizes		55	70	100	150
F	Height from Chuck body	9	10,5	14,5	18,5
H	Maximum height [mm]	10	11,5	15,5	19,5
L	Total length [mm]	24,5	26	38,5	60
	Jaw width [mm]	8	10	12	18
	Order number (without Chuck)	UFS.055.013	UFS.070.013	UFS.100.013	UFS.150.013



	Article	Designation	Package Contents
6- OR 8-JAW CHUCK MADE OF STAINLESS STEEL			
	UFS.055.000	Chuck 6 UFS 55 basic	Chuck with 1-set basic jaws without top jaws , clamping key, TORX® screwdriver, cylinder head screws (stainless)
	UFS.070.000	Chuck 6 UFS 70 basic	
	UFS.100.000	Chuck 6 UFS 100 basic	
	UFS.150.000	Chuck 8 UFS 150 basic	
	UFS.055.006	Chuck 6 UFS 55 inside	Chuck with 1-set basic jaws and top jaws for inside clamping , clamping key, TORX® screwdriver, head screws (stainless)
	UFS.070.006	Chuck 6 UFS 70 inside	
	UFS.100.006	Chuck 6 UFS 100 inside	
	UFS.150.006	Chuck 8 UFS 150 inside	
	UFS.055.007	Chuck 6 UFS 55 outside	Chuck with 1-set basic jaws and top jaws for outside clamping , clamping key, TORX® screwdriver, head screws (stainless)
	UFS.070.007	Chuck 6 UFS 70 outside	
	UFS.100.007	Chuck 6 UFS 100 outside	
	UFS.150.007	Chuck 8 UFS 150 outside	
	UFS.055.008	Chuck 6 UFS 55 bloc	Chuck with 1-set basic- and bloc jaws , clamping key, TORX® screwdriver, cylinder head screws (stainless)
	UFS.070.008	Chuck 6 UFS 70 bloc	
	UFS.100.008	Chuck 6 UFS 100 bloc	
	UFS.150.008	Chuck 8 UFS 150 bloc	
	UFS.055.009	Chuck 6 UFS 55 combi	Chuck with 1-set basic jaws and 2-set top jaws for inside and outside clamping , clamping key, TORX® screwdriver, head screws (stainless)
	UFS.070.009	Chuck 6 UFS 70 combi	
	UFS.100.009	Chuck 6 UFS 100 combi	
	UFS.150.009	Chuck 8 UFS 150 combi	



	Article	Designation	Package Contents
CLAMPING JAWS FOR UFS LINE			
	UFS.055.021	Clamping Jaws 6 UFS 55 inside	Soft top jaws for inside clamping
	UFS.070.021	Clamping Jaws 6 UFS 70 inside	
	UFS.100.021	Clamping Jaws 6 UFS 100 inside	
	UFS.150.021	Clamping Jaws 8 UFS 150 inside	
	UFS.055.022	Clamping Jaws 6 UFS 55 outside	Soft top jaws for outside clamping
	UFS.070.022	Clamping Jaws 6 UFS 70 outside	
	UFS.100.022	Clamping Jaws 6 UFS 100 outside	
	UFS.150.022	Clamping Jaws 8 UFS 150 outside	
	UFS.055.023	Clamping Jaws 6 UFS 55 bloc	Bloc jaws
	UFS.070.023	Clamping Jaws 6 UFS 70 bloc	
	UFS.100.023	Clamping Jaws 6 UFS 100 bloc	
	UFS.150.023	Clamping Jaws 8 UFS 150 bloc	

FORM FIT CLAMPING WITH BASIC- AND TOP JAWS

Technical data and order overview Typ UFS (6- oder 8-Jaw chuck)

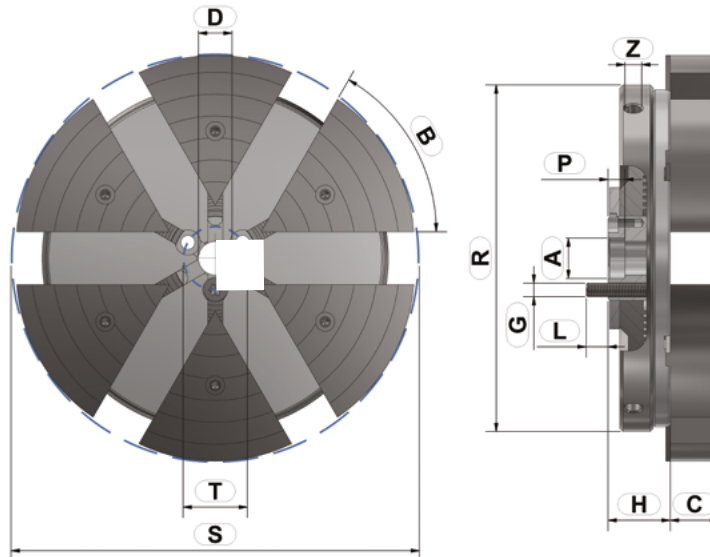

Sizes		55	70	100	150
A 0/+0,01	Interface [mm]	10	11	12	20
B	Jaw width [mm]	60	60	60	45
C	Jaw height (Standard) [mm]	9	10,5	14,5	18,5
D	∅ center hole [mm]	8	8	10	16
G	Fixing screws	3 x M3	3 x M3	3 x M4	4 x M5
H	Height without Jaws [mm]	14	16	18,5	21,5
L	Thread length [mm]	5,75	4,5	6,5	5
P	Fit length [mm]	5	5	5	5
R	Outside-∅ [mm]	58	73	103	153
S	Max. circuit diameter [mm]	73,5	87,5	119,5	183,5
T	Circle for mounting [mm]	14,5	17	18,8	28
Z	Clamping bore [mm]	-	3	5	5
	max. Spannkraft [KN]				
	Rotation speed n max. [1/min.]	2500	2500	2000	1500
	Travel path [mm im ∅]	15	23,5	36,5	47
	Weight [mm]	0,3	0,5	1	2,5
	Order number (without jaws)	UFS.055.000	UFS.070.000	UFS.100.000	UFS.150.000

JAW-SET UFS INSIDE (INTERNAL STRESS)

Technical data and order overview

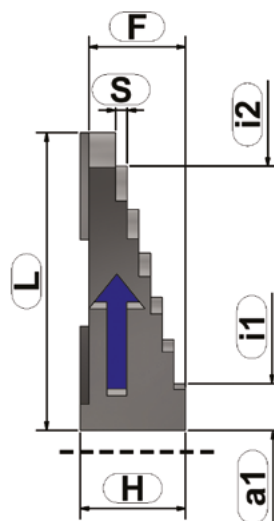

Sizes	55	70	100	150	
a1	Clamping range outside	1 - 16	1 - 24	1 - 37	1 - 48
i1	Clamping range inside min.	10 - 25	12,5 - 36	15 - 51	20 - 67
i2	Clamping range inside max.	47 - 62	52,5 - 76	80 - 116	105 - 152
F	Height from Chuck body	11	12	14,5	18,5
H	Maximum height [mm]	12	13	16	20
L	Total length [mm]	27	29,75	44,5	60
S	Step height	1,25	1,5	1,75	2
	Clamping jaw angle (degree)	60	60	60	45
	Order number (without Chuck)	UFS.055.021	UFS.070.021	UFS.100.021	UFS.150.021

JAW-SET UFS OUTSIDE (OUTSIDE CLAMPING)

Technical data and order overview

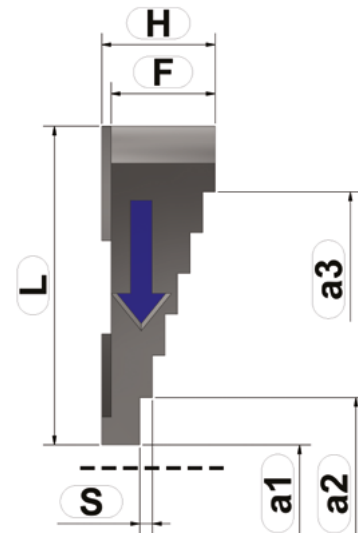

Sizes		55	70	100	150
a1	Clamping range outside	1 - 16	1 - 24	1 - 37	1 - 48
i1	Clamping range inside min.	10 - 25	13,5 - 37	15 - 51	20 - 67
i2	Clamping range inside max.	47 - 62	53,5 - 77	80 - 116	105 - 152
F	Height from Chuck body	11	12	14,5	18,5
H	Maximum height [mm]	12	13	16	20
L	Total length [mm]	27	29,75	44,5	60
S	Step height	1,25	1,5	1,75	2
	Clamping jaw angle (degree)	60	60	60	45
	Order number (without Chuck)	UFS.055.022	UFS.070.022	UFS.100.022	UFS.150.022

JAW-SET UFS BLOC (BLOCKBACK)

Technical data and order overview

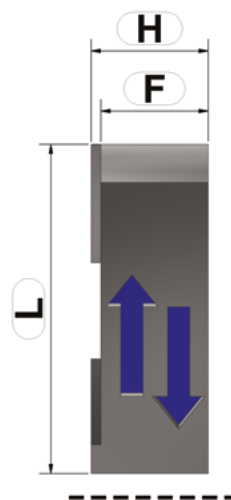

Sizes		55	70	100	150
F	Height from Chuck body	11	12	14,5	18,5
H	Maximum height [mm]	12	13	16	20
L	Total length [mm]	27	29,75	44,5	60
	Clamping jaw angle (degree)	60	60	60	45
	Order number (without Chuck)	UFS.055.023	UFS.070.023	UFS.100.023	UFS.150.023



Swiss Made